

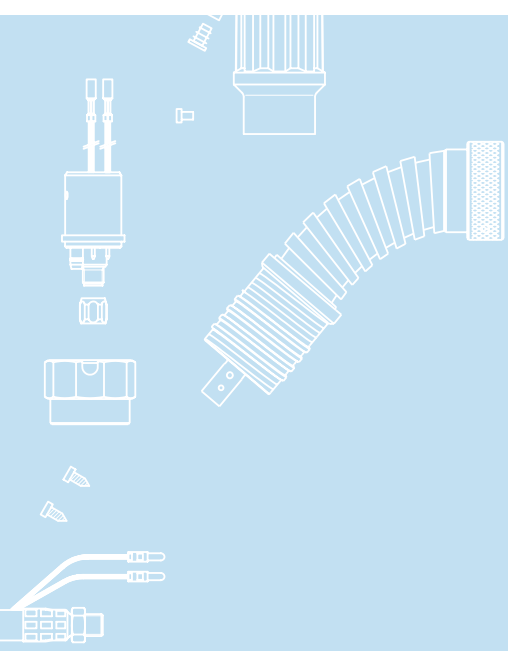

Top 2000 T i 7G E3



	TBi 7G / TBi 7W

MIG/MAG TBi 7G E3	
(10 . . .)	60%
- CO ₂ :	310 A 340 A
	1.0 - 1.6 mm
	15 /
	IEC 60974-7
1.5 m	2.00 kr

TBi 7 G E3	ESG,	50°	266P3E23_0*
*	3,4	5	



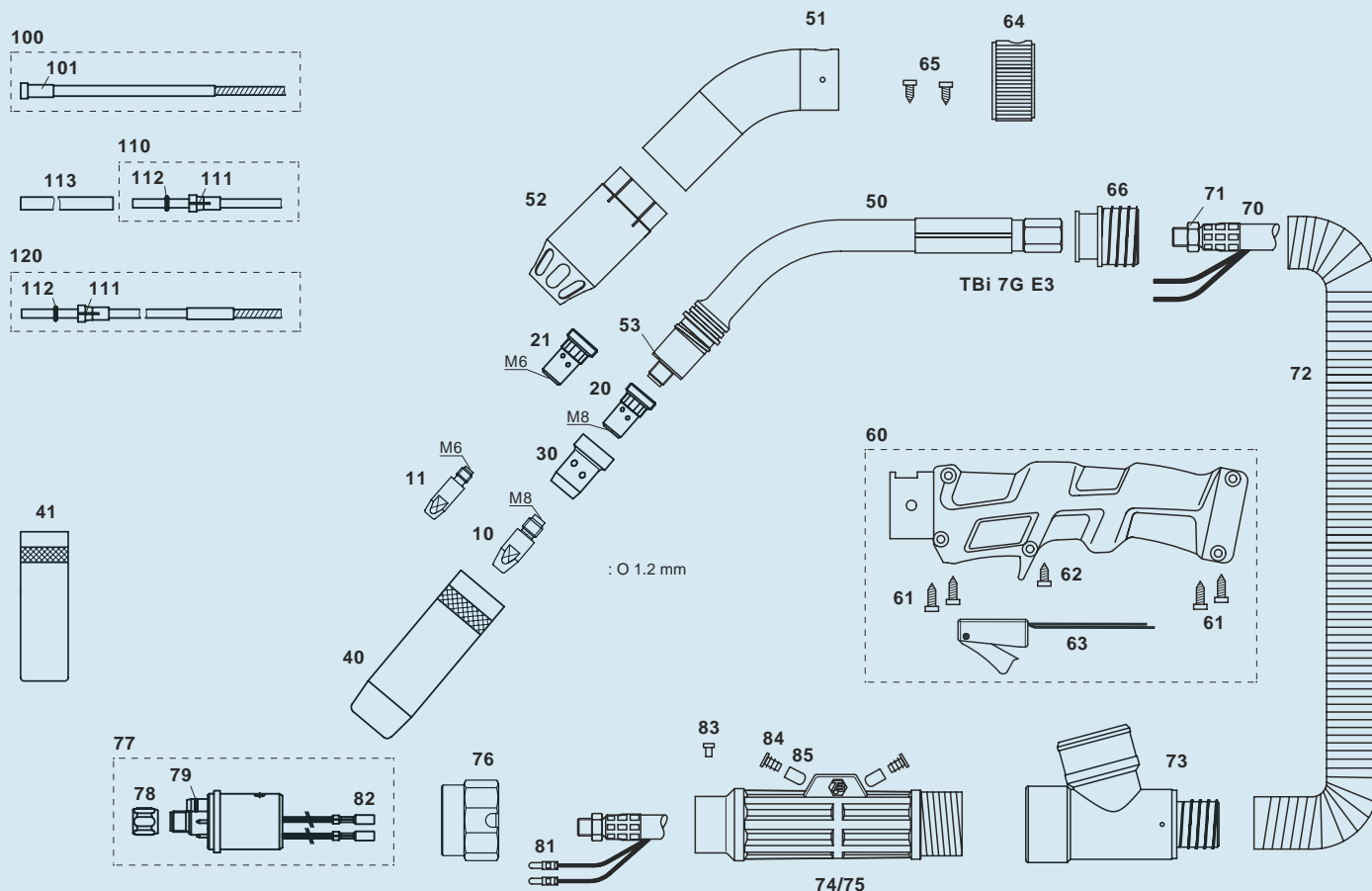

>	10	M8x30, Ecu	340P_1262*
	10	M8x30, CuCrZr	340P_3262*
	10	M8x30 Alu, Ecu	341P_1262*
	11	M6x28, Ecu	340P_1069*
	11	M6x28, CuCrZr	340P_3069*
	11	M6x28 Alu, Ecu	341P_1069*

>	20	M8 / L=25 mm	342P008033
	20	M8/L=25mm, CuCrZr	342P008171
	20	M8 / L=29 mm	342P008133
	21	M6 / L=25 mm	342P006033
	21	M6 / L=29 mm	342P006133

>	30		130P002026
	30		130P002019
	30		130P002031

>	40	., 16.0 mm	345P022171
	41	., 19.0 mm	345P021171

	50	TBi 7G E3	266P101004
	51	TBi 360/511/7G/7W E3	234P102035
	52	TBi 360/511/7G/7W E3	200P002043
	53		130P002004
	60	. T i E2/E3	380P220606

	61	3.5x14.0 mm	100P797101
	62	, , TBi E3	100P008411
	63		600P101046
	64		200P102001
	65		100P797103
	66	38 mm	274P102011
	70	50	359P5011_0*
	71	6- M10x1	101P002005
	72	D=38 mm	306P384600
	73	38 mm	200P101012
	74	(.75)	701P102070
	75	(.74)	701P102071
	76		701P001013
	77	ESG	701P001048
	78	M10x1	701P002005
	79	4.0x1.0 mm (.)	365P100040
	81		375P000004
	82		375P000003
	83	. M4x6	100P008401
	84		200P102006
	85		395P000004

>	100	(x.40 m)	1.0-1.2	324P2045_4*
	100	(.40 m)	1.2-1.6	324P2545_4*
	101	4.5 mm		330P025045
	110	(x.50 m)	1.0-1.2	326P2040_5*
	110	(x.50 m)	1.2-1.6	326P2747_5*
	111	/	4.0 mm	331P020040
	111	/	4.7 mm	331P027047
	112	3.50x1.50mm (.)		365P150035
	113	/	5x4.4mm, L=150mm	329P544150
	120	. Alu (x.50 m)	1.0-1.2	328P2040_A*

> = , .08 0.8 3 3 .

© 2012 TBi Industries GmbH. All rights reserved. Subject to change without notice. Warranty only when using original TBi consumables and spare parts. Excerpts and reprints not permitted. Nr. DOKP113412, 07/2012.