

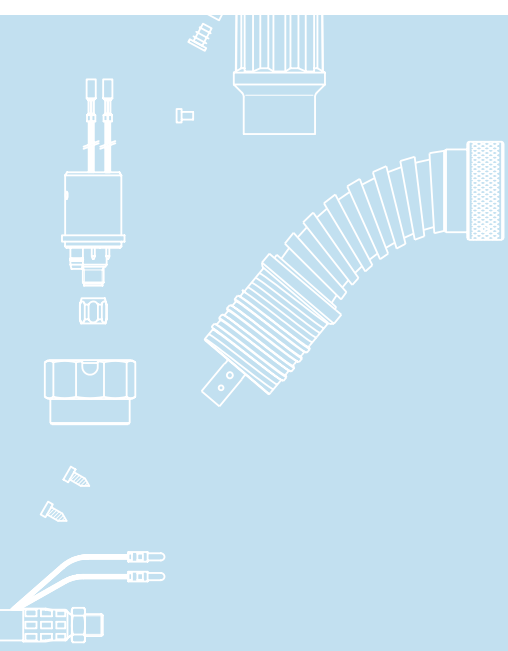

Classic TBi 250 E3



	TBi 250

		MIG/MAG TBi 250 E3	
(10 .)	60%		
-	:	200 A	
- CO ₂ :		230 A	
		0.8 - 1.2 mm	
		10 /	
		IEC 60974-7	
	1.5 m	1.40 kr	

TBi 250 E3	ESG,	50°	204P3X13_0*
*	3, 4	5	

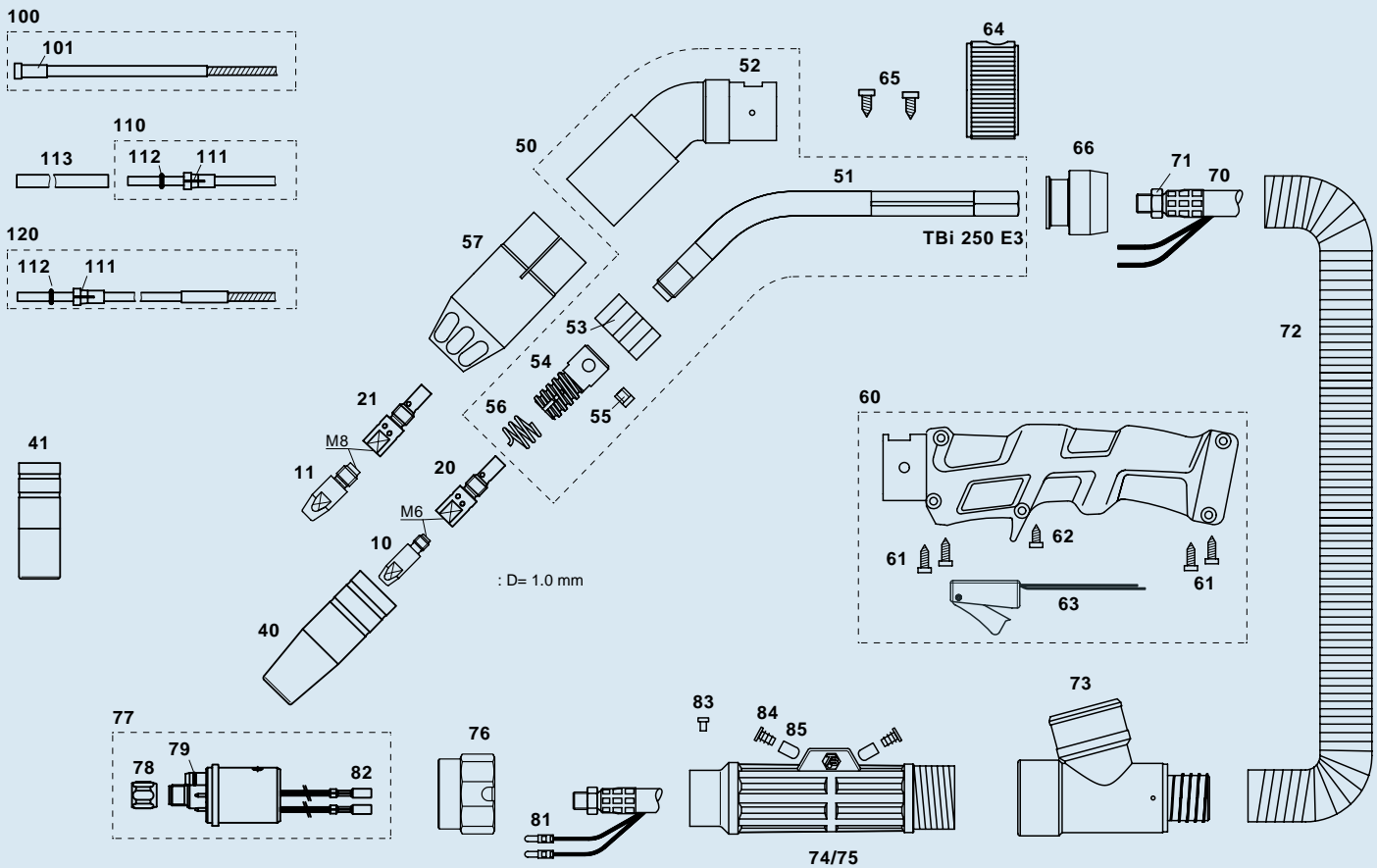

>	10	M6x28, Ecu	340P_1069*
	10	M6x28, CuCrZr	340P_3069*
	10	M6x28 Alu, Ecu	341P_1069*
	11	M8x30, Ecu	340P_1262*
	11	M8x30, CuCrZr	340P_3262*
	11	M8x30 Alu, Ecu	341P_1262*

>	20	M6 / L=35 mm	342P006003
	21	M8 / L=35 mm	342P008003

>	40	. 15.0 mm	345P012003
	40	. 15.0 mm	345P012303
	41	. 20.0 mm	345P011003
	41	. 20.0 mm	345P011303

	50	TBi 250 E3,	204P001065
	51	TBi 250 E3	204P001063
	52	TBi 250 E3	204P001064
	53	TBi 250 E3	204P002013
	54	TBi 250 E3	103P002031
	55	. M3x4	100P008402
	56	TBi 250/252/351	103P002006
	57	TBi 250 E3	204P002030
	60	, , TBi E2/E3	380P220606
	61	3.5x14.0 mm	100P797101
	62	, TBi E3	100P008411
	63	,	600P101046
	64	,	200P102003

	65		100P797103
	66	. 29 mm	252P102026
	70	. 25	359P2511_0*
	71	6- M10x1	101P002005
	72	D=29 mm	306P293600
	73	. 29 mm	200P101013
	74	(.75)	701P102070
	75	(.74)	701P102071
	76		701P001013
	77	ESG	701P001048
	78	M10x1	701P002005
	79	4.0x1.0 mm (.)	365P100040
	81		375P000004
	82		375P000003
	83	. M4x6	100P008401
	84		200P102006
	85		395P000004

	100	(x.40 m) 0.8-1.0	324P1545_4*
>	100	(x.40 m) 1.0-1.2	324P2045_4*
	101	4.5 mm	330P025045
	110	(x.50 m) 0.6-0.9	326P1540_5*
	110	(x.50 m) 1.0-1.2	326P2040_5*
	111	/ . 4.0 mm	331P020040
	112	3.50x1.50 mm (.)	365P150035
	113	/ 5x4.4 mm, L=150mm	329P544150
	120	. Alu (x.50 m) 1.0-1.2	328P2040_A*

> =
* . , .08 0,8 3 3 .

© 2012 TBi Industries GmbH. All rights reserved. Subject to change without notice. Warranty only when using original TBi consumables and spare parts. Excerpts and reprints not permitted. Nr. DOKP113522, 07/2012.