

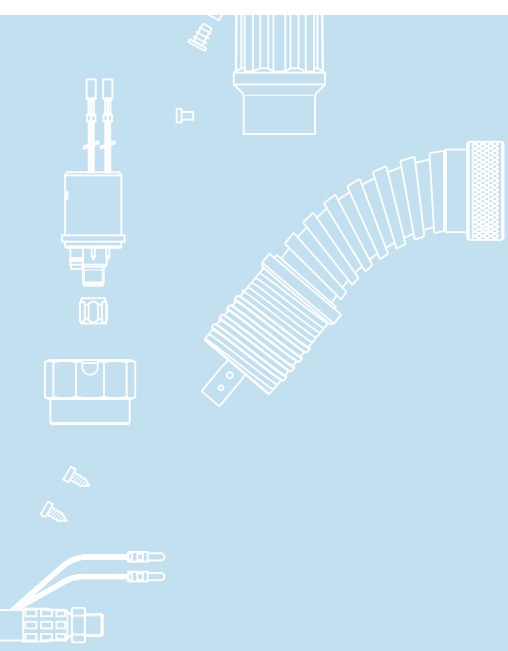

## Classic T i 150 E3



	TBi 150

MIG/MAG TBi 150 E3	
(10 . . )	60%
- C 2:	150 A 180 A
	0.6 - 1.0 mm
	8 /
	IEC 60974-7
1.5 m	1.20 кг

T i 150 E3	ESG,	50°	202P3X13_0*
*	3,4	5	

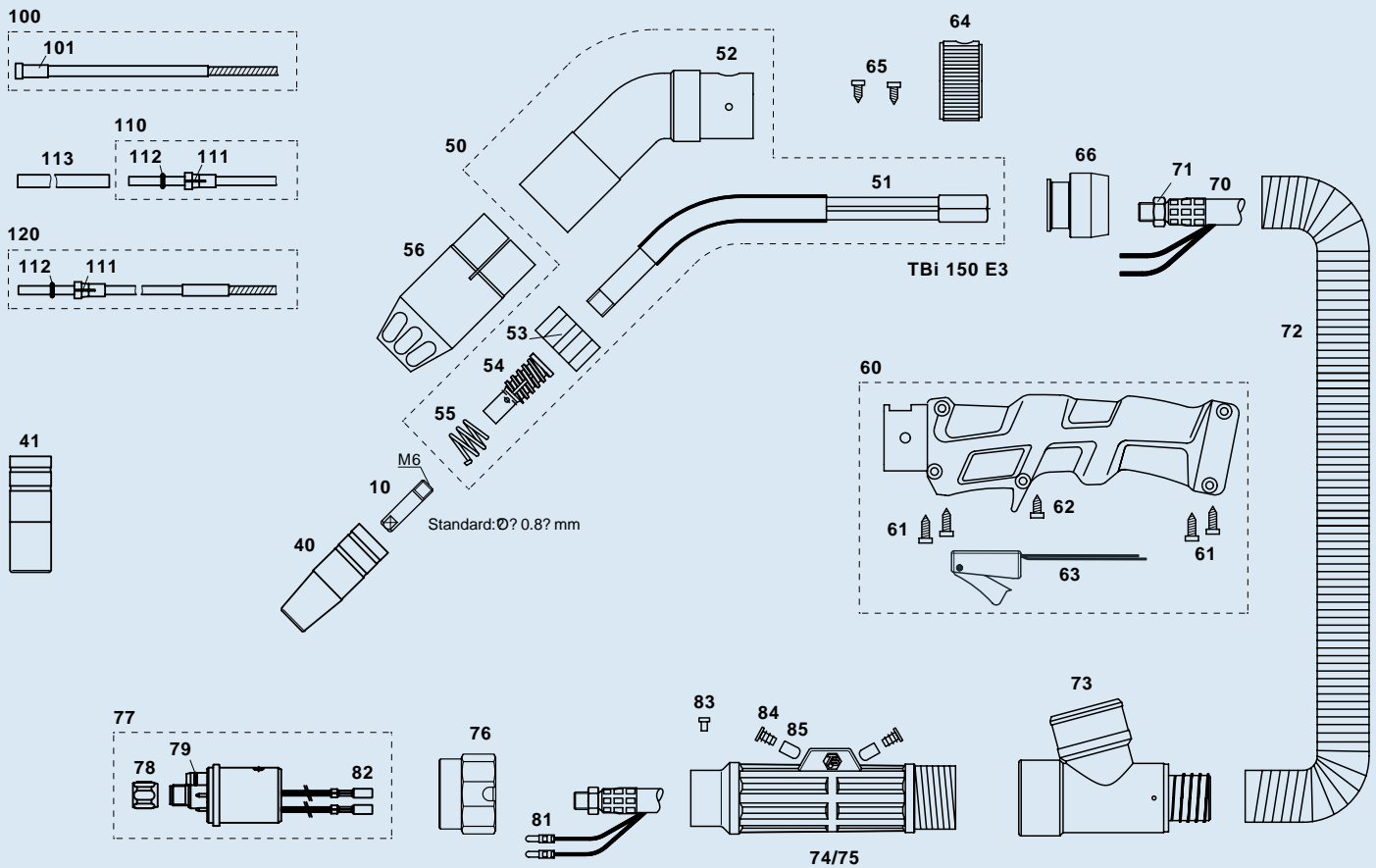

>	10	M6x25, Ecu	340P_1073*
	10	M6x25, CuCrZr	340P_3073*
	10	M6x25 Alu, Ecu	341P_1073*

>	40	. 12.0 mm	345P012002
	40	. 12.0 mm	345P012402
	41	. 16.0 mm	345P011002
	41	. 16.0 mm	345P011402

	50	TBi 150 E3,	202P001023
	51	TBi 150 E3	202P001022
	52	TBi 150 E3	202P001020
	53	TBi 150 E3	202P002007
	54	TBi 150	102P002037
	55	TBi 140/145/150	102P002011
	56	TBi 150 E3	202P002010
	60	., TBi E3	380P220606
	61	3.5x14.0 mm	100P797101
	62	, TBi E3	100P008411
	63		600P101046
	64		200P102003
	65		100P797103
	66	. 29 mm	252P102026
	70	16	359P1611_0*
	71	6- M10x1	101P002005
	72	D=29 mm	306P293600

	73	. 29 mm	200P101013
	74	( . 75)	701P102070
	75	( . 74)	701P102071
	76		701P001013
	77	ESG	701P001048
	78	M10x1	701P002005
	79	4.0x1.0 mm ( . )	365P100040
	81		375P000004
	82		375P000003
	83	. M4x6	100P008401
	84		200P102006
	85		395P000004

	100	(x.40) 0.6-0.9	324P1338_4*
>	100	(x.40 m) 0.8-1.0	324P1545_4*
	101	8 mm	330P015040
	101	4.5 mm	330P025045
	110	(x.50 m) 0.6-0.9	326P1540_5*
	111	/ 4.0 mm	331P020040
	112	3.50x1.50 mm ( . )	365P150035
	113	5x4.4 mm, L=150mm	329P544150
	120	/ Alu (x.50 m) 1.0-1.2	328P2040_A*

> = . ,08 0,8 3 3 .

©2012 TBi Industries GmbH. All rights reserved. Subject to change without notice. Warranty only when using original TBi consumables and spare parts. Excerpts and reprints not permitted. Nr. DOKP113501, 07/2012.