

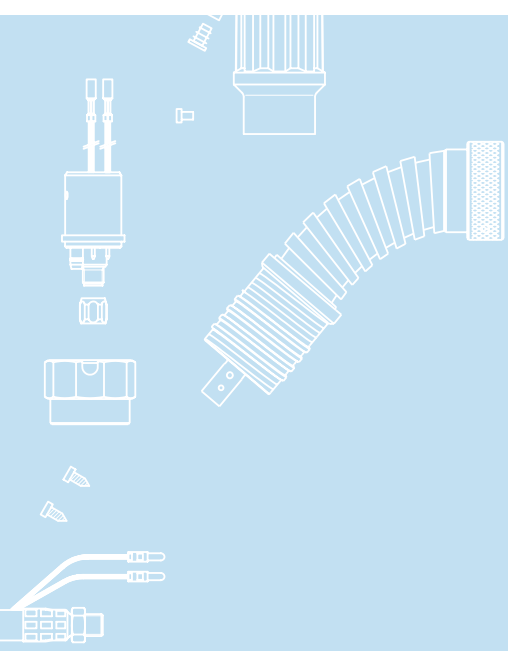

Top 2000 T i 7G E2



	TBi 7G / 7W

	MIG/MAG	TBi 7G E2
(10 . .)	60%	
- CO ₂ :	310 A 340 A	
	1.0 - 1.6 mm	
	15 /	
	IEC 60974-7	
1.5 m	1.90 kr	
	p	

TBi 7 G E2	ESG,	50°	266P3X23_0*
*	3,4	5	



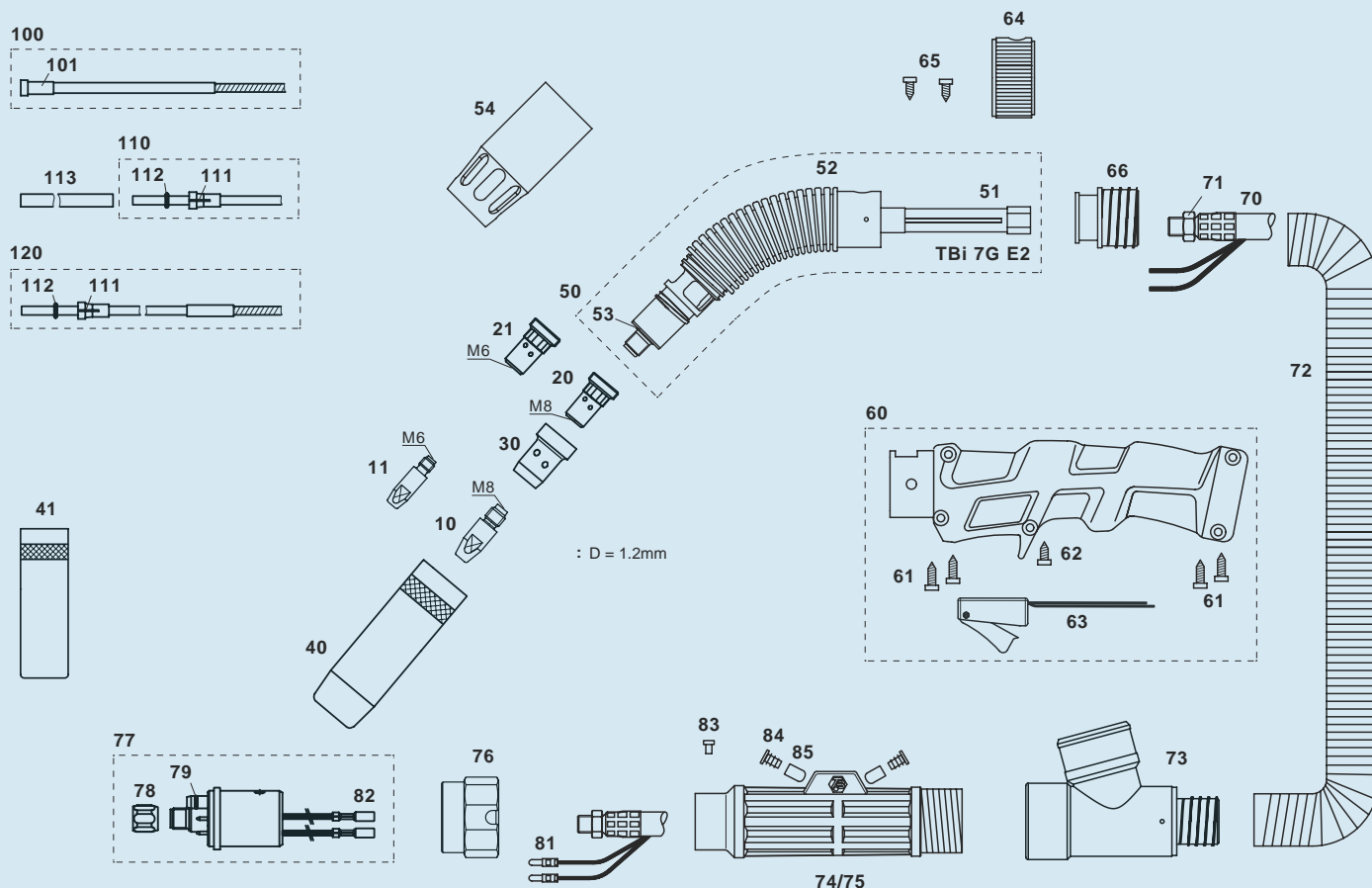

>	10	M8x30, Ecu	340P_1262*
	10	M8x30, CuCrZr	340P_3262*
	10	M8x30 Alu, Ecu	341P_1262*
	11	M6x28, Ecu	340P_1069*
	11	M6x28, CuCrZr	340P_3069*
	11	M6x28 Alu, Ecu	341P_1069*

>	20	M8 / L=25 mm	342P008033
	20	M8/L=25 mm, CuCrZr	342P008171
	20	M8 / L=29 mm	342P008133
	21	M6 / L=25 mm	342P006033
	21	M6 / L=29 mm	342P006133

>	30		130P002026
	30		130P002019
	30		130P002031

>	40	. 16.0 mm	345P022171
	41	. 19.0 mm	345P021171

	50	TBi 7G E2,	266P101001
	51	TBi 7G E2	266P101002
	52	TBi 7G E2 / 7W E2	274P101012
	53		274P102022
	54	TBi 7G E2 / 7W E2	274P102040

	60		., TBi E2/E3	380P220606
	61	3.5x14.0 mm		100P797101
	62		, TBi E3	100P008411
	63			600P101046
	64			200P102003
	65			100P797103
	66		38	274P102011
	70	50		359P5011_0*
	71	6- M10x1		101P002005
	72	D=38		306P384600
	73		38	200P101012
	74	(.75)		701P102070
	75	(.74)		701P102071
	76			701P001013
	77	ESG		701P001048
	78	M10x1		701P002005
	79	4.0x1.0 mm (.)		365P100040
	81			375P000004
	82			375P000003
	83	. M4x6		100P008401
	84			200P102006
	85			395P000004

>	100	(x.40 m)	1.0-1.2	324P2045_4*
	100	(x.40 m)	1.2-1.6	324P2545_4*
	101	4.5 mm		330P025045
	110	(x.50 m)	1.0-1.2	326P2040_5*
	110	(x.50 m)	1.2-1.6	326P2747_5*
	111	/	4.0 mm	331P020040
	111	/	4.7 mm	331P027047
	112	3.50x1.50 mm (.)		365P150035
	113	/	5x4.4 mm, L=150mm	329P544150
	120	Alu (x.50 m)	1.0-1.2	328P2040_A*

> = , .08 0.8 3 3 .

© 2012 T i Industries GmbH. All rights reserved. Subject to change without notice. Warranty only when using original TBi consumables and spare parts. Excerpts and reprints not permitted. Nr. DOKP113202, 07/2012.